

January 2022
Enero 2022

VERS.
2022



FULGOR

**A SUPER
BRIGHT LIGHT**
LUZ MUY
BRILLANTE



LED VISION

| SINCE 2007 |





4th GENERATION
ROAD LIGHTING

ILUMINACIÓN VIAL
DE 4^a GENERACIÓN

The present catalogue cancels and substitutes all the precedent catalogues.
The Litek logo is a registered trademark, and all rights are reserved.
The present catalogue is the property of Litek srl and can not be totally or in a part reproduced without the written authorization of Litek srl.
To improve our articles Litek srl reserves the right to change their feature.

Este catálogo cancela sustituye los anteriores.
El logotipo Litek es una marca registrada y detiene todos los derechos.
El presente catálogo es propiedad de Litek srl y no puede ser copiado por completo o en partes, sin la autorización por escrito de Litek srl.
Litek srl tiene facultad de modificar los productos para mejorarne el desempeño.

FULGOR 1

High efficiency LED luminaire for streets and urban city centers

Luminaria LED para alumbrado público y mobiliario urbano

4th generation/4^a generación

Design R&D Litek

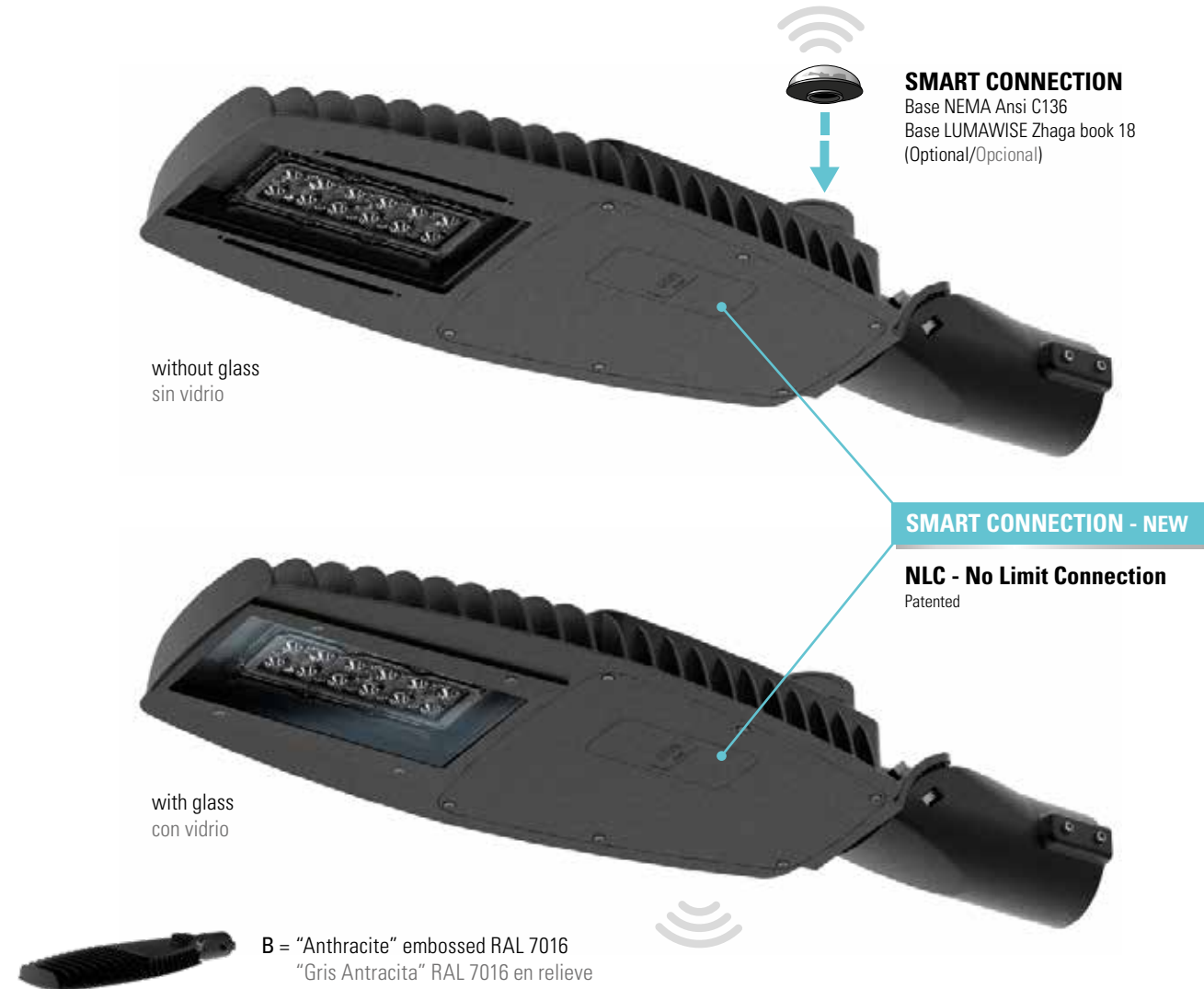

High efficiency LED street lighting fixture with body, adjustable pole head and technical compartment cover in die-cast aluminum (R&D Litek Design), self-cleaning design and minimum wind exposure specifically designed for high heat exchange LED technology, long lasting protective treatment by means of external polyester powder coating in "Anthracite" RAL 7016 embossed colour ("Silver" RAL 9006 embossed, or other colours, on request). Optical unit sealed with PC/PMMA street optics (optional on request, extra-clear 4mm (0.2") tempered safety glass protective screen), variable light distribution, neutral light colour 4000 K or warm 3000 K or very warm 2200 K, CRI 70 (80 and 90 on request), fully certified cut-off light emission in accordance with Standards against light pollution. Optical units made of MULTIDIE high-power LEDs, with direct welding on 15/10 pure aluminum circuits; Vdc constant current LED drive. Several types of system functionalities/management (OF, DM, TLC, NLC, NEMA, LUMAWISE); LITEK heat dissipation system as TCS (Thermal Cooling System)

with very high heat exchange. Power supply 100/277 Volt 50/60Hz, power factor corrected to cos-fi ≥0,9 @115Vac, output type Class 2, electronic ballast with very high efficiency microprocessor control with overvoltage protection up to 6kV. Luminaire with IP66 protection degree of both the technical and optical compartments, AWG17 type power supply cable already externally terminated by means of a variable clamping cable gland, impact protection degree IK08 (with glass), IK09 (without glass). External stainless-steel bolts, two different types of pole connection devices suitable both for vertical and/or horizontal shanks Ø 40/46/60 mm (1.6"/1.8"/2.4") or 60/76 mm (2.4"/3.0") and adjustable in steps of 5° from 0° to 180°, dimensions 754x278x80 mm (29.7"x10.9"x3.2") and weight 5 Kg (11 lbs). Several accessories are available, cULus, Dekra certifications: international scheme CB, ENEC and CE marking. Luminaire is Made in Italy.



FULGOR 1

SAVIGNANO S.R. - ITALY

Luminaria LED de alumbrado público de alta eficiencia con cuerpo, punta poste ajustable y cubierta del compartimento técnico en aluminio fundido a presión (diseño LITEK R&D), diseño autolimpiante y exposición mínima al viento específicamente diseñado con alto intercambio de calor para la tecnología LED. Tratamiento de protección duradero mediante pintura de poliéster con recubrimiento de polvo externo en relieve "Gris Antracita" RAL 7016 (relieve "Gris Plata" RAL 9006, u otro color, bajo pedido). Unidad óptica monobloque sellada con óptica de carretera PC / PMMA (opcional bajo pedido, pantalla de vidrio de seguridad templado extra claro de 4 mm (0.2"), con distribución de luz variable, color de luz neutra 4000 K o cálido 3000 K o muy cálido 2200 K, ópticas certificadas totalmente cut-off contra la contaminación lumínica. Grupos ópticos compuestos de LED MULTIDIE de alta potencia, con refundición directa en circuitos de aluminio puro 15/10; Controlador LED em corriente constante Vdc. Diferentes tipos de funcionamiento / gestión (OF, DM, TLC, NLC, NEMA, LUMAWISE); Sistema de disipación de calor TCS (Thermal Cooling

System) redundante, con intercambio de calor muy alto. Fuente de alimentación 100/277Volt 50/60Hz, corrección del factor de potencia a cos-fi ≥0,9 @115Vac, salida Class 2, driver electrónico con control por microprocesador con muy alta eficiencia y con protección contra sobretensiones hasta 6k. Luminaria con grado de protección IP66 tanto para el compartimento técnico como para el compartimento óptico, cable de alimentación tipo AWG17 ya encabezado externamente por medio de un prensaestopas con ajuste variable, grado de protección contra impactos IK08 (con vidrio), IK09 (sin vidrio). Tornillería externas de acero inoxidable, dos tipos diferentes de fijación a poste adecuados para postes verticales o brazos horizontales Ø 40/46/60 mm (1,6"/1,8"/2,4") o 60/76 mm (2,4"/3,0") y ajustables en pasos de 5° de 0° a 180°, dimensiones 754x278x80 mm (29.7"x10.9"x3.2") y peso 5 Kg (11 lbs). Diferentes accesorios disponibles, cULus, certificaciones Dekra: esquema internacional CB, ENEC y marcado CE. La luminaria es Made in Italy.

Version/Item Item	Wattage Potencia nominal (W)	Luminaire consumption Consumo (W)	Current Corriente (mA)	LED Flux Flujo LED Lm (Tj = 85°C, 4000K CRI70)	LED Flux Flujo LED Lm (Tj=85°C, 3000K CRI70)	LED Flux Flujo LED Lm (Tj=85°C, 2200K CRI70)
F1032BA4504B13	32	34	450	6062	5638	5068
F1036BA5104B13	36	39	510	6780	6305	5668
F1052BA7004B13	52	56	700	8952	8325	7484
F1048BA3504B13	48	54	350	9652	8976	8069
F1063BA4504B13	63	69	450	12124	11275	10136
F1076BA5304B13	76	83	530	14031	13049	11730
F1092BA6304B13	92	98	630	16337	15193	13658

OPTICS - ÓPTICAS

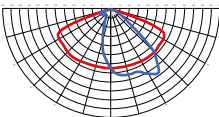
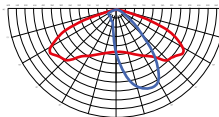
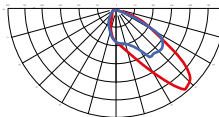
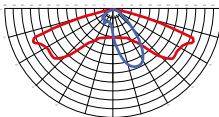
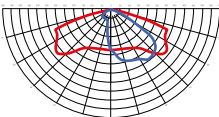
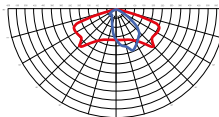
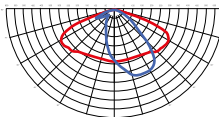
 <p>BA=AS13 ME Street IESNA Type II (very short) without glass/sin vidrio BB= AS13 ME Street IESNA Type II (very short) with glass/con vidrio</p>	 <p>BE=AS15 Wide Pedestrian IESNA Type II (very short) without glass/sin vidrio BF=AS15 Wide Pedestrian IESNA Type II (very short) with glass/con vidrio</p>	 <p>BI=AS17 Pedestrian Crossings IESNA Type II (very short) without glass/sin vidrio BL=AS17 Pedestrian Crossings IESNA Type II (very short) with glass/con vidrio</p>	 <p>BM=AS18 Very Extensive IESNA Type II (long) without glass/sin vidrio BN= AS18 Very Extensive IESNA Type II (long) with glass/con vidrio</p>
 <p>BO=AS19 Very Extensive IESNA Type III (long) without glass/sin vidrio BP= AS19 Very Extensive IESNA Type III (long) with glass/con vidrio</p>	 <p>BQ=AS20 Very Extensive IESNA Type II/III (long) without glass/sin vidrio BR= AS20 Very Extensive IESNA Type III (long) with glass/con vidrio</p>	 <p>BS=AS21 Very Extensive IESNA Type III (medium) without glass/sin vidrio BT= AS21 Very Extensive IESNA Type III (medium) with glass/con vidrio</p>	

DIMENSIONS - DIMENSIONES

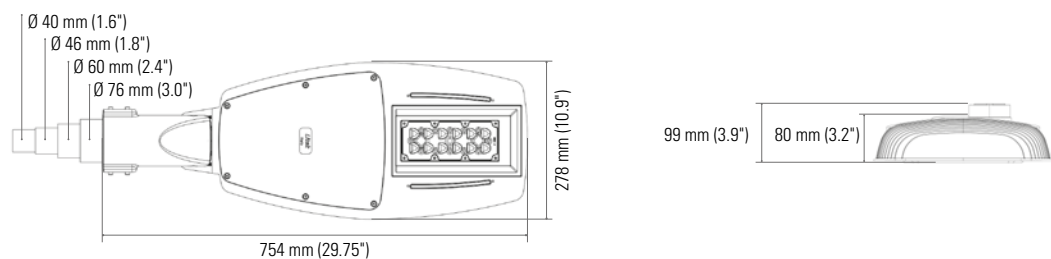

ACCESSORIES - ACCESORIOS

 <p>F1TPB604640 d.60/46/40 mm (2.4\"/> </p>	 <p>F1TPB7660 d.76/60 mm (3.0\"/> </p>
 <p>F1TPP60B L.150 mm - d.60 mm (5.9\"/> </p>	 <p>CONSEIP3P 3-pin IP66 disconnecting connector Conector seccionador de 3 polos IP66</p>

UNIVERSAL TOP-POST - PUNTA POSTE UNIVERSAL

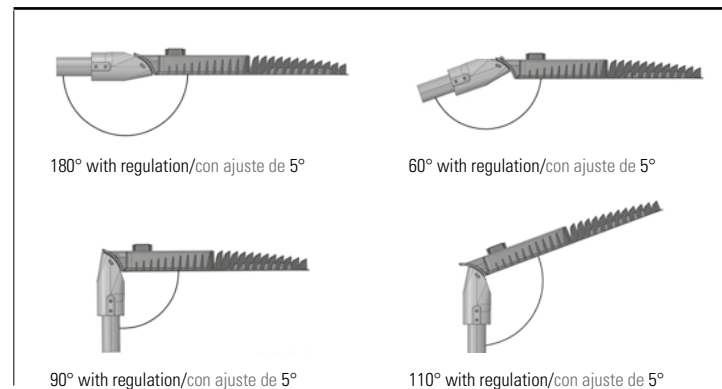

VERSIONS/OPTIONS - VERSIONES/OPCIONES

▲ Without glass - Sin vidrio	■ With glass - Con vidrio	Wattage Potencia nominal LED	Optic Óptica	LED Current Corriente LED	Light color Color claro	Luminaire color Color da luminaria	Type of operation Tipologías de funcionamiento	Output type Salida
		032 = 32W	▲ BA = AS13 ME Street	350 = 350mA	1= 2200 K	B = Anthracite Antracita	1 = OF On-off	3 = Class 2
		036 = 36W	■ BB = AS13 ME Street	450 = 450mA	3 = 3000 K		3 = DM Dimmable/ Regulable 1-10 Vdc	
		052 = 52W	▲ BE = AS15 Wide Pedestrian	510 = 510mA	4 = 4000 K		4 = TLC Remote control Control remoto	
		048 = 48W	■ BF = AS15 Wide Pedestrian	530 = 530mA			7 = NEMA Ansi C136 base/base	
		063 = 63W	▲ BI = AS17 Pedestrian Crossings	630 = 630mA			8 = LUMAWISE Zhaga book 18 base/base	
		076 = 76W	■ BL = AS17 Pedestrian Crossings	700 = 700mA			9 = NLC No Limit Connection	
		092 = 92W	▲ BM = AS18 Very Extensive					
			■ BN = AS18 Very Extensive					
			▲ BO = AS19 Very Extensive					
			■ BP = AS19 Very Extensive					
			▲ BQ = AS20 Very Extensive					
			■ BR = AS20 Very Extensive					
			▲ BS = AS21 Advance Street					
			■ BT = AS21 Advance Street					

PLEASE NOTE: for all values /information on other optics and/or technical characteristics and/or tolerances, ask to the LITEK technical office (tech@litekamerica.com) or refer to the section of the latest Catalog; the performance values of the luminaires may change without notice and/or according to market availability. Device output flux depends on the optics used.

TENGA EN CUENTA: para todos los valores / información sobre otras ópticas y / o especificaciones técnicas y / o tolerancias, también consulte a departamento técnico de Litek (tech@litekamerica.com) o consulte la sección técnica del catálogo más actualizado vigente; Los valores de rendimiento pueden cambiar sin previo aviso y / o según la disponibilidad del mercado. El flujo luminoso de la luminaria depende de la óptica utilizada.

CODE COMPOSITION EXAMPLE - EJEMPLO DE COMPOSICIÓN DEL CÓDIGO

F1 032 BA 450 4 B 1 3	F1	032	BA	450	4	B	1	3
Item number Número de artículo	Luminaire/ Luminaria F1 = Fulgor 1	32W	Optic/Óptica BA	450mA	4000 K	Anthracite color Gris Antracita	OF On-off	Class 2

General:	
Series	Fulgor 1
Version / Item	See table
Type	LED luminaire for street lighting
Materials:	
Mechanical structure	Die-cast Aluminum
Degree of protection	IP66, impact resistance IK08 (with glass), IK09 (without glass version)
Screen	Extra clear 4mm (0.2") tempered glass for requested version only
Surface protection	Long-lasting polyester powder coating
Screws	External bolts in stainless steel Aisi-304
Color	Anthracite RAL-7016 embossed (Silver RAL-9006 embossed on request)
Weight	5 Kg. (11 lbs) Approx. (without glass)
Dimensions	754x278x80 mm (29.7"x10.9"x3.2")
Inclination	From 0° to 180° with 5° steps
Recommendations - Referencas:	
Compliance	cULus, ENEC, CE marking and international certification CB
Applications:	
Lighting	Road, Street, cycle-pedestrian, perimeter buildings
Mounting	Horizontal and/or vertical pole head for Ø 40/46/60 mm (1.6"/1.8"/2.4") or 60/76 mm (2.4"/3.0") with accessories supplied in painted die-cast aluminium and variable inclination of 5° from 0° to 180°
Power supply cable	AWG17 type cable
Accessories	F1TPB604640, F1TPB7660, F1TPP60B, CONSEIP3P
Optics:	
Lumen Output (LED)	From 6062 to 16337 Lm @4000 K
Light color	4000 K (3000 K, 2200 K on request)
Optics	AS13, AS15, AS17, AS18, AS19, AS20, AS21 High efficiency PC/PMMA optics
Color rendering index - CRI	70 (80 or 90 on request)
Electrical characteristics:	
LED Engine	MULTIDIE high-power LEDs, with direct welding on 15/10 pure aluminium circuits
Wattage	From 32 to 92W
Luminaire Consumption	From 34 to 98W
PFC Cos-fi	≥0,9
Power supply	Voltage 100/277 Vac, frequency 50/60 Hz
Driver current	From 350 to 700 mA
Output type	Class 2
Heat management	TCS - Thermal Cooling System
Functionality	OF, DM, TLC, NLC, NEMA, LUMAWISE
Protection	Surge common mode / differential up to 6kV
Ambient storage temperature	-40° C / + 85° C
Ambient Operating Temperature	-40° C / + 50° C
LED lifetime	>100'000hr L80B10 @700 mA
Reference Standards Certification	cULus, ENEC, CE marking and international certification CB

Note: Do not use the luminaire during daytime and/or in direct sunlight.

General:	
Serie	Fulgor 1
Versión / Artículo	Ver tabla
Tipo	Luminaria LED para alumbrado público
Materiales:	
Estructura mecanica	Fundición a presión de aluminio
Grado de protección	IP66, resistencia al impacto IK08 (con vidrio), IK09 (vers. sin vidrio)
Pantalla	Vidrio templado extra claro de 4 mm (0.2") bajo pedido
Protección + tratamiento superficial	Recubrimiento en polvo de poliéster de larga duración
Tornillos	Pernos externos en acero inoxidable Aisi-304
Color	Gris Antracita RAL 7016 en relieve (Gris Plata RAL 9006 en relieve sobre pedido)
Peso	5 Kg. (11 lbs) Aprox. (sin vidrio)
Dimensiones	754x278x80 mm (29.7"x10.9"x3.2")
Inclinación	De 0° a 180° en pasos de 5°
Recomendaciones - referencias:	
Conformidad	cULus, ENEC, marcado CE y certificación internacional CB
Aplicaciones:	
Iluminación	Calle, Carretera, ciclopeatonal, edificios perimetrales
Montaje	Punta Postes horizontales y / o verticales para Ø 40/46/60 mm (1.6"/1.8"/2.4") o 60/76 mm (2.4"/3.0") con los accesorios suministrados en aluminio inyectado pintado e inclinación variable de 5° de 0° a 180°
Cable de alimentación	Cable de tipo AWG17
Accesorios	F1TPB604640, F1TPB7660, F1TPP60B, CONSEIP3P
Ópticas:	
Flujo nominal	De 6062 a 16337 Lm @4000 K
Color claro	4000 K (3000 K, 2200 K bajo pedido)
Ópticas	AS13, AS15, AS17, AS18, AS19, AS20, AS21 Óptica PC/PMMA de alta eficiencia
Color rendering index - CRI	70 (80 o 90 bajo pedido)
Características electricas:	
Grupo de LED	MULTIDIE carretera, con fundición directa en circuitos de aluminio puro desde 15/10
Potencia nominal LED	De 32 a 92W
Consumo da lumnaria	De 34 a 98W
PFC Cos-fi	≥0,9
Potencia	Voltaje 100/277 Vac, frecuencia 50/60 Hz
Corriente Driver	De 350 a 700 mA
Salida	Class 2
Disipación	TCS - Thermal Cooling System
Funcionamientos	OF, DM, TLC, NLC, NEMA, LUMAWISE
Protección	Sobretensiones en modo común / diferencial hasta 6kV
Temperatura de almacenamiento	-40° C / + 85° C
Temperatura de funcionamiento	-40° C / + 50° C
Vida de fuente LED	>100'000hr L80B10 @700 mA
Estándares de referencia Certificaciones	cULus, ENEC, marcado CE y certificación internacional CB
Notas:	
No utilice el dispositivo durante el día y / o bajo la luz solar directa.	

Marks/Marcas: UNI EN ISO9001:2015 N°2764 CERTIFIED QUALITY CALIDAD CERTIFICADA UNI EN ISO 14001:2015 CERTIFIED ENVIRONMENTAL MANAGEMENT SYSTEM

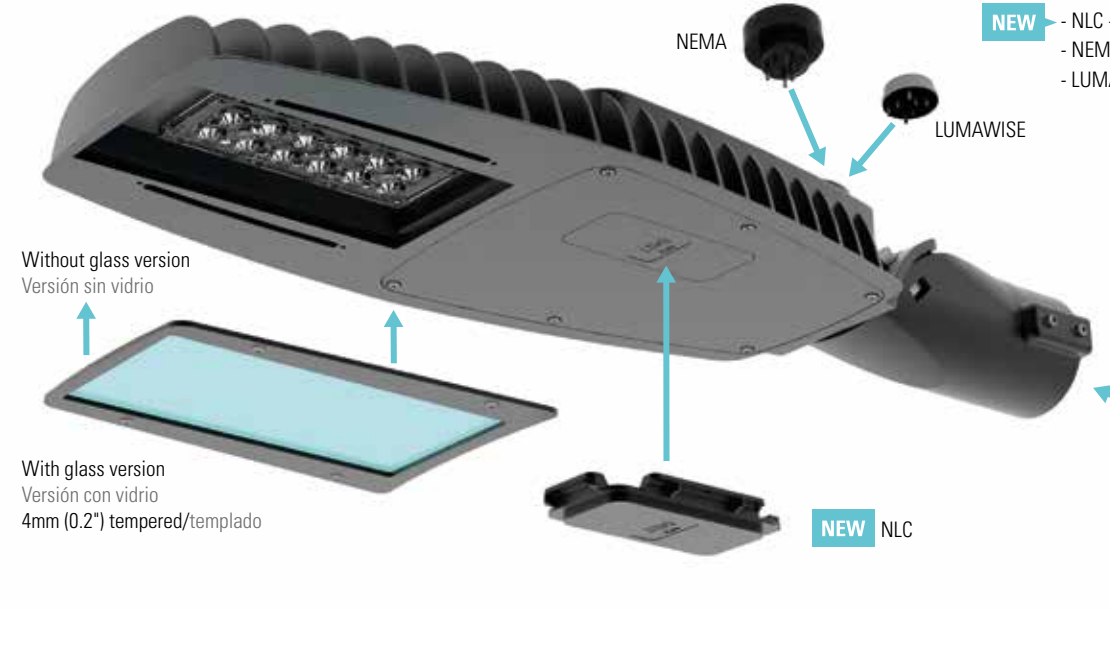

FUNCTIONS - TIPOLOGÍAS DE FUNCIONAMIENTOS

- OF on-off
- DM Dimmable 1-10Vdc
- TLC Remote control
- NLC - No Limit Connection
- NEMA - Ansi C136 base
- LUMAWISE - Zhaga book 18 base

OPTICS - ÓPTICAS

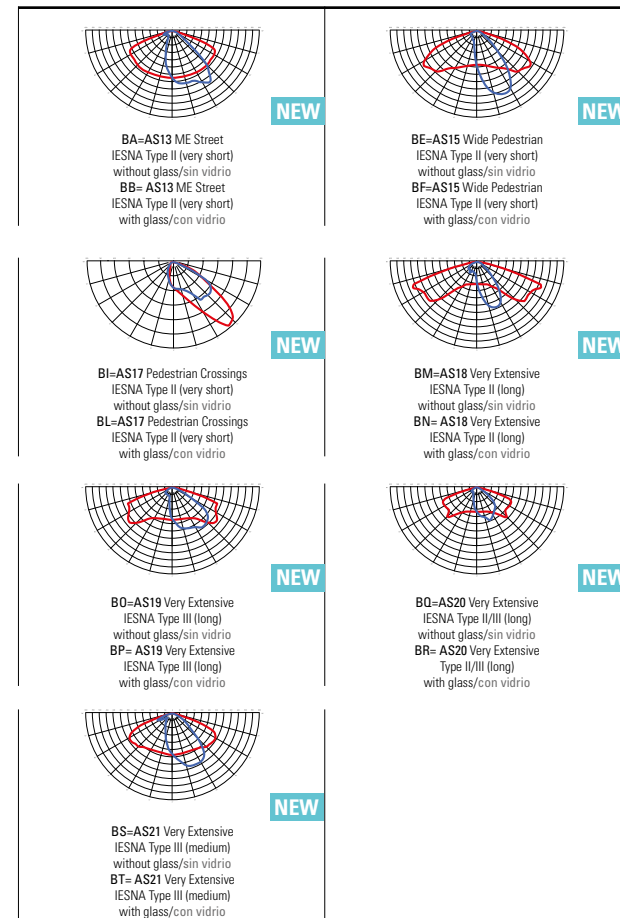

AVAILABLE TOP-POST SIZE - TIPOS DIFERENTES DE FIJACIÓN A POSTE

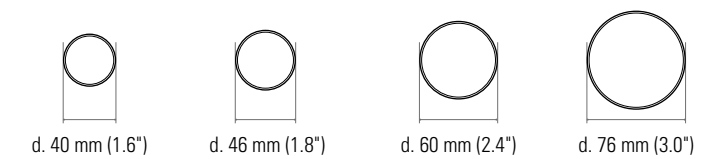

ACCESSORIES - ACCESORIOS

F1TPB604640 d.60/46/40 mm (2.4"/1.8"/1.6") Universal top-post Punta poste universal	F1TPB7660 d.76/60 mm (3.0"/2.4") Universal top-post Punta poste universal
F1TPP60B L.150 mm - d.60 mm (5.9"- 2.4") Wall top-post Brazo de pared	CONSEIP3P 3-pin IP66 disconnecting connector Conector seccionador de 3 polos IP66

WATTAGE - POTENCIA NOMINAL LED

32W
36W
52W
48W
63W
76W
92W

LIGHT COLOR - COLOR CLARO

4000 K
3000 K
2200 K

FULGOR 2

High efficiency LED luminaire for streets and urban city centers

Luminaria LED para alumbrado público y mobiliario urbano

4th generation/4^a generación

Design R&D Litek



High efficiency LED street lighting fixture with body, adjustable pole head and technical compartment cover in die-cast aluminum (R&D Litek Design), self-cleaning design and minimum wind exposure specifically designed for high heat exchange LED technology, long lasting protective treatment by means of external polyester powder coating in "Anthracite" RAL 7016 embossed colour ("Silver" RAL 9006 embossed, or other colours, on request). Optical unit sealed with PC/PMMA street optics (optional on request, extra-clear 4mm (0.2") tempered safety glass protective screen), variable light distribution, neutral light colour 4000 K or warm 3000 K or very warm 2200 K, CRI 70 (80 and 90 on request), fully certified cut-off light emission in accordance with Standards against light pollution. Optical units made of MULTIDIE high-power LEDs, with direct welding on 15/10 pure aluminum circuits; Vdc constant current LED drive. Several types of system functionalities/management (OF, DM, TLC, NLC, NEMA, LUMAWISE); LITEK heat dissipation system as TCS (Thermal Cooling System)

with very high heat exchange. Power supply 100/305Volt 50/60Hz, power factor corrected to cos-fi ≥0.9 @115Vac, output type Class 2, electronic ballast with very high efficiency microprocessor control with overvoltage protection up to 6kV. Luminaire with IP66 protection degree of both the technical and optical compartments, AWG17 type power supply cable already externally terminated by means of a variable clamping cable gland, impact protection degree IK08 (with glass), IK09 (without glass). External stainless-steel bolts, two different types of pole connection devices suitable both for vertical and/or horizontal shanks Ø 40/46/60 mm (1.6"/1.8"/2.4") or 60/76 mm (2.4"/3.0") and adjustable in steps of 5° from 0° to 180°, dimensions 760x350x90mm (29.9"x13.8"x3.5") and weight 7 Kg (15.4 lbs). Several accessories are available, cULus, Dekra certifications: international scheme CB, ENEC and CE marking. Luminaire is Made in Italy.



FULGOR 2

Luminaria LED de alumbrado público de alta eficiencia con cuerpo, punta poste ajustable y cubierta del compartimento técnico en aluminio fundido a presión (diseño LITEK R&D), diseño autolimpiante y exposición mínima al viento específicamente diseñado con alto intercambio de calor para la tecnología LED. Tratamiento de protección duradero mediante pintura de poliéster con recubrimiento de polvo externo en relieve "Gris Antracita" RAL 7016 (relieve "Gris Plata" RAL 9006, u otro color, bajo pedido). Unidad óptica monobloque sellada con óptica de carretera PC / PMMA (opcional bajo pedido, pantalla de vidrio de seguridad templado extra claro de 4 mm (0.2"), con distribución de luz variable, color de luz neutra 4000 K o cálido 3000 K o muy cálido 2200 K, ópticas certificadas totalmente cut-off contra la contaminación lumínica. Grupos ópticos compuestos de LED MULTIDIE de alta potencia, con refundición directa en circuitos de aluminio puro 15/10; Controlador LED em corriente constante Vdc. Diferentes tipos de funcionamiento / gestión (OF, DM, TLC, NLC, NEMA, LUMAWISE); Sistema de disipación de calor TCS (Thermal Cooling

System) redundante, con intercambio de calor muy alto. Fuente de alimentación 100/305Volt 50/60Hz, corrección del factor de potencia a cos-fi ≥0.9 @115Vac, salida Class 2, driver electrónico con control por microprocesador con muy alta eficiencia y con protección contra sobretensiones hasta 6kV. Luminaria con grado de protección IP66 tanto para el compartimento técnico como para el compartimento óptico, cable de alimentación tipo AWG17 ya encabezado externamente por medio de un prensaestopas con ajuste variable, grado de protección contra impactos IK08 (con vidrio), IK09 (sin vidrio). Tornillería externas de acero inoxidable, dos tipos diferentes de fijación a poste adecuados para postes verticales o brazos horizontales Ø 40/46/60 mm (1,6"/1,8"/2,4") o 60/76 mm (2,4"/3,0") y ajustables en pasos de 5° de 0° a 180°, dimensiones 760x350x90mm (29.9"x13.8"x3.5") y peso 7 Kg (15.4 lbs). Diferentes accesorios disponibles, cULus, certificaciones Dekra: esquema internacional CB, ENEC y marcado CE. La luminaria es Made in Italy.

Version/Item Item	Wattage Potencia nominal (W)	Luminaire consumption Consumo (W)	Current Corriente (mA)	LED Flux Flujo LED Lm (Tj = 85°C, 4000K CRI70)	LED Flux Flujo LED Lm (Tj=85°C, 3000K CRI70)	LED Flux Flujo LED Lm (Tj=85°C, 2200K CRI70)
F2076BA5304B13	76	82	530	14031	13049	11730
F2098BA6804B13	98	104	680	17460	16238	14597
F2110BA5104B13	110	119	510	20340	18916	17004
F2133BA6154B13	133	142	615	23995	22315	20060
F2148BA6804B13	148	158	680	26190	24357	21895
F2147BA3404B13	147	157	340	28195	26221	23571

OPTICS - ÓPTICAS

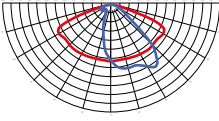
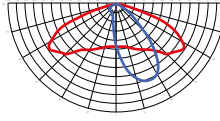
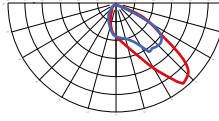
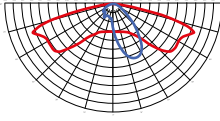
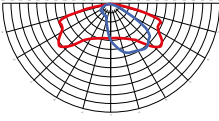
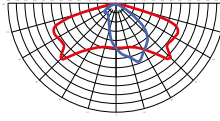
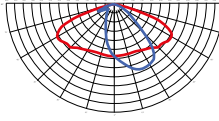
 <p>BA=AS13 ME Street IESNA Type II (very short) without glass/sin vidrio BB=AS13 ME Street IESNA Type II (very short) with glass/con vidrio</p>	 <p>BE=AS15 Wide Pedestrian IESNA Type II (very short) without glass/sin vidrio BF=AS15 Wide Pedestrian IESNA Type II (very short) with glass/con vidrio</p>	 <p>BI=AS17 Pedestrian Crossings IESNA Type II (very short) without glass/sin vidrio BL=AS17 Pedestrian Crossings IESNA Type II (very short) with glass/con vidrio</p>	 <p>BM=AS18 Very Extensive IESNA Type II (long) without glass/sin vidrio BN=AS18 Very Extensive IESNA Type II (long) with glass/con vidrio</p>
 <p>BO=AS19 Very Extensive IESNA Type III (long) without glass/sin vidrio BP=AS19 Very Extensive IESNA Type III (long) with glass/con vidrio</p>	 <p>BQ=AS20 Very Extensive IESNA Type II/III (long) without glass/sin vidrio BR=AS20 Very Extensive Type II/III (long) with glass/con vidrio</p>	 <p>BS=AS21 Very Extensive IESNA Type III (medium) without glass/sin vidrio BT=AS21 Very Extensive IESNA Type III (medium) with glass/con vidrio</p>	



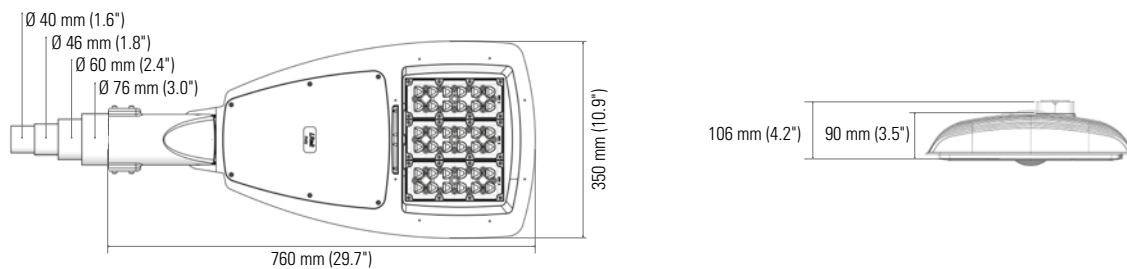

DIMENSIONS - DIMENSIONES

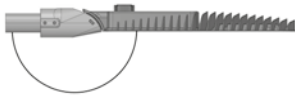

ACCESSORIES - ACCESORIOS

 <p>F2TPB604640 d.60/46/40 mm (2.4\"/> </p>	 <p>F2TPB7660 d.76/60 mm (3.0\"/> </p>
 <p>F2TPP60B L.150 mm - d.60 mm (5.9\"/> </p>	 <p>CONSEIP3P 3-pin IP66 disconnecting connector Conector seccionador de 3 polos IP66</p>

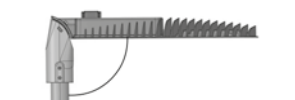
UNIVERSAL TOP-POST - PUNTA POSTE UNIVERSAL

 <p>180° with regulation/con ajuste de 5°</p>	 <p>60° with regulation/con ajuste de 5°</p>
 <p>90° with regulation/con ajuste de 5°</p>	 <p>110° with regulation/con ajuste de 5°</p>

VERSIONS/OPTIONS - VERSIONES/OPCIONES

Without glass - Sin vidrio With glass - Con vidrio	Wattage Potencia nominal LED	Optic Optic	LED Current Corriente LED	Light color Color claro	Luminaire color Color da luminaria	Type of operation Tipologías de funcionamiento	Output type Salida
▲	076 = 76W	▲ BA = AS13 ME Street	340 = 340mA	1= 2200 K	B = Anthracite Antracita	1 = OF On-off	3 = Class 2
■	098 = 98W	■ BB = AS13 ME Street	510 = 510mA	3 = 3000 K		3 = DM Dimmable/ Regulable 1-10 Vdc	
▲	110 = 110W	▲ BE = AS15 Wide Pedestrian	530 = 530mA	4 = 4000 K		4 = TLC Remote control Control remoto	
■	133 = 133W	■ BF = AS15 Wide Pedestrian	615 = 615mA			7 = NEMA Ansi C136 base/base	
▲	148 = 148W	▲ BI = AS17 Pedestrian Crossings	680 = 680mA			8 = LUMAWISE Zhaga book 18 base/base	
■	147 = 147W	■ BL = AS17 Pedestrian Crossings				9 = NLC No Limit Connection	
▲		▲ BM = AS18 Very Extensive					
■		■ BN = AS18 Very Extensive					
▲		▲ BO = AS19 Very Extensive					
■		■ BP = AS19 Very Extensive					
▲		▲ BQ = AS20 Very Extensive					
■		■ BR = AS20 Very Extensive					
▲		▲ BS = AS21 Advance Street					
■		■ BT = AS21 Advance Street					

PLEASE NOTE: for all values /information on other optics and/or technical characteristics and/or tolerances, ask to the LITEK technical office (tech@litekamerica.com) or refer to the section of the latest Catalog; the performance values of the luminaires may change without notice and/or according to market availability. Device output flux depends on the optics used.
TENGA EN CUENTA: para todos los valores / información sobre otras ópticas y / o tolerancias, también consulte a departamento técnico de Litek (tech@litekamerica.com) o consulte la sección técnica del catálogo más actualizado vigente; Los valores de rendimiento pueden cambiar sin previo aviso y / o según la disponibilidad del mercado. El flujo luminoso de la luminaria depende de la óptica utilizada.

CODE COMPOSITION EXAMPLE - EJEMPLO DE COMPOSICIÓN DEL CÓDIGO

F2 076 BA 530 4 B 1 3	F2	076	BA	530	4	B	1	3
Item number Número de artículo	Luminaire/ Luminaria F2 = Fulgor 2	76W	Optic/Óptica BA	530mA	4000 K	Anthracite color Gris Antracita	OF On-off	Class 2

General:	
Series	Fulgor 2
Version / Item	See table
Type	LED luminaire for street lighting
Materials:	
Mechanical structure	Die-cast Aluminium
Degree of protection	IP66, impact resistance IK08 (with glass), IK09 (without glass version)
Screen	Extra clear 4mm (0.2") tempered glass for requested version only
Surface protection	Long-lasting polyester powder coating
Screws	External bolts in stainless steel Aisi-304
Color	Anthraxite RAL-7016 embossed (Silver RAL-9006 embossed on request)
Weight	7 Kg. (15.4 lbs) Approx. (without glass)
Dimensions	760x350x90 mm (29.7"x10.9"x3.5")
Inclination	From 0° to 180° with 5° steps
Recommendations - References:	
Compliance	cULus, ENEC, CE marking and international certification CB
Applications:	
Lighting	Road, Street, cycle-pedestrian, perimeter buildings
Mounting	Horizontal and/or vertical pole head for Ø 40/46/60 mm (1.6"/1.8"/2.4") or 60/76 mm (2.4"/3.0") with accessories supplied in painted die-cast aluminium and variable inclination of 5° from 0° to 180°.
Power supply cable	AWG17 type cable
Accessories	F2TPB604640, F2TPB7660, F2TPP60B, CONSEIP3P
Optics:	
Lumen Output (LED)	From 14031 to 28195 Lm @4000 K
Light color	4000 K (3000 K, 2200 K on request)
Optics	AS13, AS15, AS17, AS18, AS19, AS20, AS21 High efficiency PC/PMMA optics
Color rendering index - CRI	70 (80 or 90 on request)
Electrical characteristics:	
LED Engine	MULTIDIE high-power LEDs, with direct welding on 15/10 pure aluminium circuits
Wattage	From 76 to 148 W
Luminaire Consumption	From 82 to 158 W
PFC Cos-fi	≥0,9
Power supply	Voltage 100/277 Vac, frequency 50/60 Hz
Driver current	From 340 to 680 mA
Output type	Class 2
Heat management	TCS - Thermal Cooling System
Functionality	OF, DM, TLC, NLC, NEMA, LUMAWISE
Protection	Surge common mode / differential up to 6kV
Ambient storage temperature	-40° C / + 85° C
Ambient Operating Temperature	-40° C / + 50° C
LED lifetime	>100'000hr L80B10 @700 mA
Reference Standards Certification	cULus, ENEC, CE marking and international certification CB

Note: Do not use the luminaire during daytime and/or in direct sunlight.

General:	
Serie	Fulgor 2
Versión / Artículo	Ver tabla
Tipo	Luminaria LED para alumbrado público
Materiales:	
Estructura mecanica	Fundición a presión de aluminio
Grado de protección	IP66, resistencia al impacto IK08 (con vidrio), IK09 (vers. sin vidrio)
Pantalla	Vidrio templado extra claro de 4 mm (0.2") bajo pedido
Protección + tratamiento superficial	Recubrimiento en polvo de poliéster de larga duración
Tornillos	Pernos externos en acero inoxidable Aisi-304
Color	Gris Antracita RAL 7016 en relieve (Gris Plata RAL 9006 en relieve sobre pedido)
Peso	7 Kg. (15.4 lbs) Aprox. (sin vidrio)
Dimensiones	760x350x90 mm (29.7"x10.9"x3.5")
Inclinación	De 0° a 180° en pasos de 5°
Recomendaciones - referencias:	
Conformidad	cULus, ENEC, marcado CE y certificación internacional CB
Aplicaciones:	
Iluminación	Calle, Carretera, ciclopeatonal, edificios perimetrales
Montaje	Punta Postes horizontales y / o verticales para Ø 40/46/60 mm (1.6"/1.8"/2.4") o 60/76 mm (2.4"/3.0") con los accesorios suministrados en aluminio inyectado pintado e inclinación variable de 5° de 0° a 180°
Cable de alimentación	Cable de tipo AWG17
Accesorios	F2TPB604640, F2TPB7660, F2TPP60B, CONSEIP3P
Ópticas:	
Flujo nominal	De 14031 a 28195 Lm @4000 K
Color claro	4000 K (3000 K, 2200 K bajo pedido)
Ópticas	AS13, AS15, AS17, AS18, AS19, AS20, AS21 Óptica PC/PMMA de alta eficiencia
Representación del color - IRC - RA	70 (80 or 90 bajo pedido)
Características eléctricas:	
Grupo de LED	MULTIDIE carretera, con fundición directa en circuitos de aluminio puro desde 15/10
Potencia nominal LED	De 76 a 148 W
Consumo da lumnaria	De 82 a 158 W
PFC Cos-fi	≥0,9
Potencia	Voltaje 100/277 Vac, frecuencia 50/60 Hz
Corriente Driver	De 340 a 680 mA
Salida	Class 2
Disipación	TCS - Thermal Cooling System
Funcionamientos	OF, DM, TLC, NLC, NEMA, LUMAWISE
Protección	Sobretensiones en modo común / diferencial hasta 6kV
Temperatura de almacenamiento	-40° C / + 85° C
Temperatura de funcionamiento	-40° C / + 50° C
Vida de fuente LED	>100'000hr L80B10 @700 mA
Estándares de referencia Certificaciones	cULus, ENEC, marcado CE y certificación internacional CB

Notas: No utilice el dispositivo durante el día y / o bajo la luz solar directa.

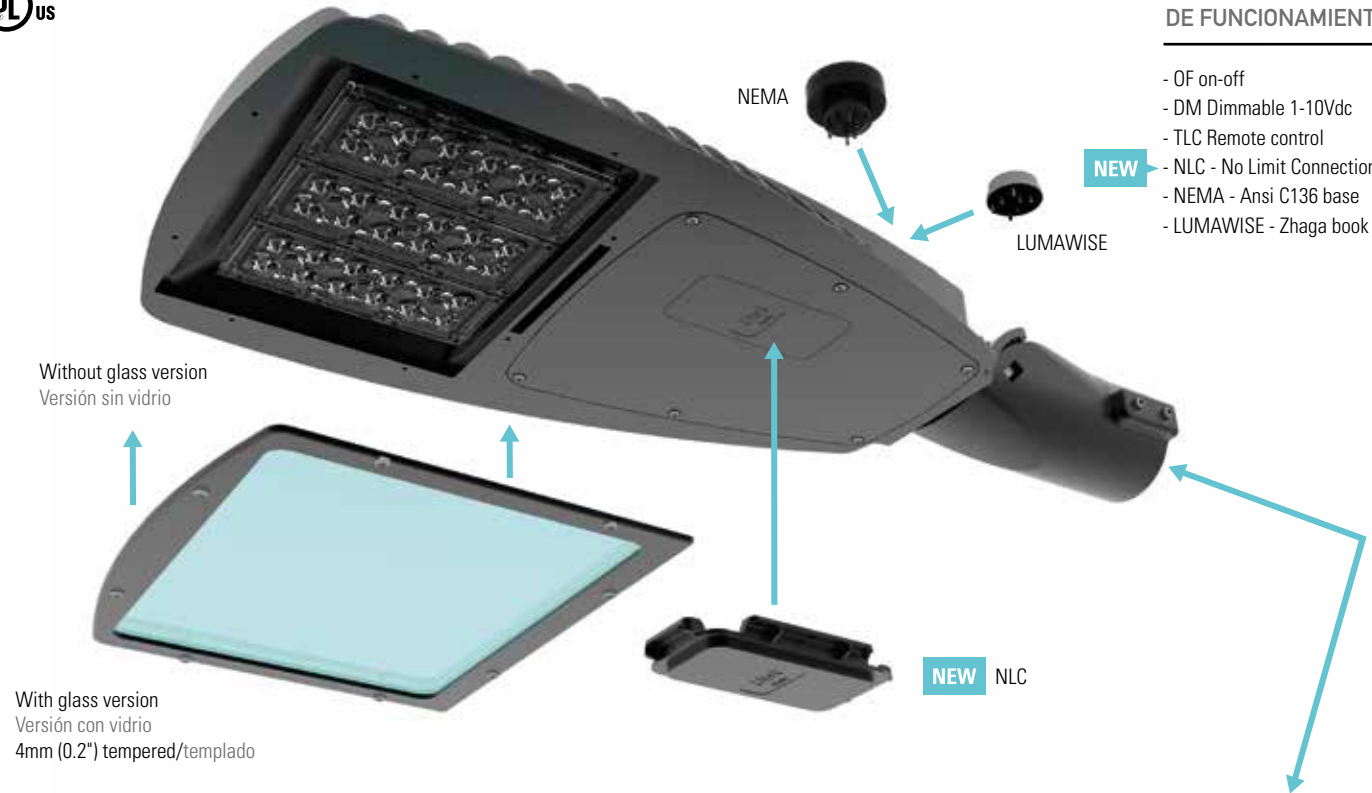

FUNCTIONS - TIPOLOGÍAS DE FUNCIONAMIENTOS

- OF on-off
- DM Dimmable 1-10Vdc
- TLC Remote control
- NLC - No Limit Connection
- NEMA - Ansi C136 base
- LUMAWISE - Zhaga book 18 base

OPTICS - ÓPTICAS

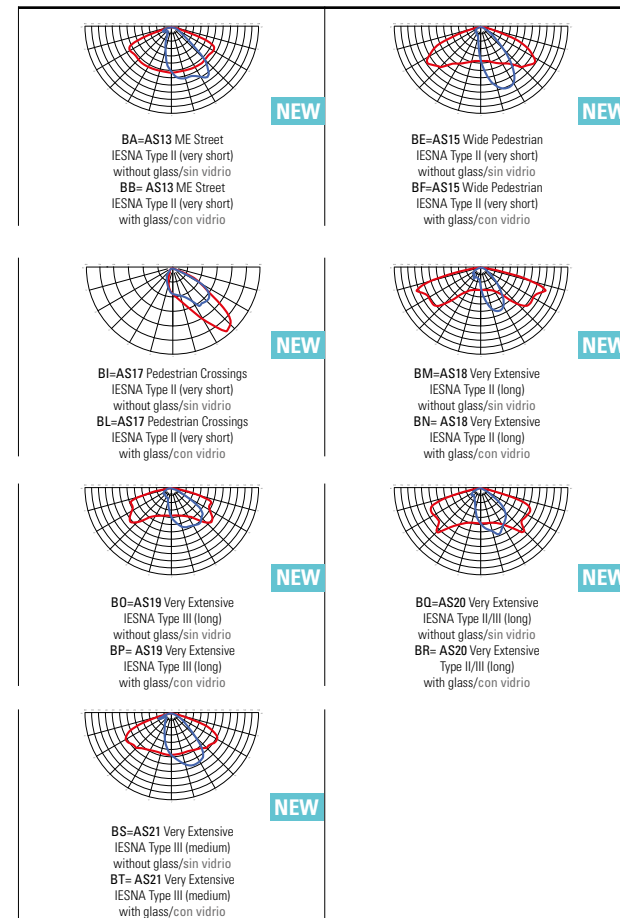

AVAILABLE TOP-POST SIZE - TIPOS DIFERENTES DE FIJACIÓN A POSTE

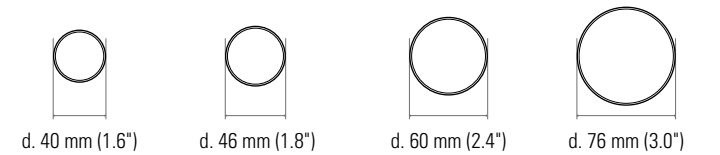

ACCESSORIES - ACCESORIOS

F2TPB604640 d.60/46/40 mm (2.4"/1.8"/1.6") Universal top-post Punta poste universal	F2TPB7660 d.76/60 mm (3.0"/2.4") Universal top-post Punta poste universal
F2TPP60B L.150 mm - d.60 mm (5.9" - 2.4") Wall top-post Brazo de pared	CONSEIP3P 3-pin IP66 disconnecting connector Conector seccionador de 3 polos IP66

WATTAGE - POTENCIA NOMINAL LED

76W
98W
110W
133W
148W
147W

LIGHT COLOR - COLOR CLARO

4000 K
3000 K
2200 K

Marks/Marcas:





SAVIGNANO S.R. - ITALY

litek[®]

lighting

LED VISION

| SINCE 2007 |



LITEK AMERICA CORP.

18 Bridge Street 2a Brooklyn, NY 11201

Tel. +1 718 522 5575

Mob. +1 929 732 5437

Commercial & general information

com@litekamerica.com

Technical office

tech@litekamerica.com

Warehouse & Logistic

35 Watterson St Dayton, OH 45417

www.litekamerica.com



LITEK ITALY & EUROPE

Litek Srl

Via delle Industrie 3b

47824 Poggio Torriana (RN) - Italy

Tel. +39 0541627208

Commercial & general information

com@litek.it

Technical office

tecnico@litek.it

www.litek.it



LITEK MEXICO

Torre Chapultepec

Av. Chapultepec, 15

Colonia Ladrón de Guevara

CP 44600 Guadalajara

Jalisco - Mexico

com@litekamerica.com

www.litek.it/es



LITEK ILUMINAÇÃO LTDA.

Rua Lauro Müller, 116 - 32º andar

Botafogo, Rio de Janeiro - RJ, CEP

22290-160

BRASIL

com@litek.com.br

www.litek.com.br



Twitter: @LitekLEDvision



UNI EN ISO 9001:2015 N°2764 CERTIFIED QUALITY - CALIDAD CERTIFICADA



UNI EN ISO 14001:2015 - CERTIFIED ENVIRONMENTAL MANAGEMENT SYSTEM